



Company: _____

Job: _____ #Item: _____

Notes: _____

3"X2" Switch Boxes Gangable with Conduit KO's, 1/2" Setback



APPLICATIONS

Used to house wiring devices such as switches and outlets

FEATURES

- Gangable switch boxes offer the option of constructing a box to hold two or more devices
- Reference the Box Selection section in the front of this catalog for complete description of bracket types and features
- Material: Steel

COMPLIANCES

Single gang, two gang, 4 in. square, and single gang gangable UL listed steel boxes are acceptable for use in 2-hour fire rated walls.

GENERAL INFORMATION

Wiring System: _____ Conduit

CONFIGURATION

- End Knockouts: _____ (2) 1/2 in
- Bracket Type: _____ TS, for Metal or Wood Studs
- Bracket Setback: _____ 1/2 in
- Side Knockout(s): _____ (2) 1/2 in
- Bottom Knockout(s): _____ (2) 1/2 in

DRAWING DIMENSIONS

- Dimension A: _____ 2-1/2 in
- Dimension B: _____ 7 in
- Dimension C: _____ 2-13/64 in

MEASUREMENTS

- Depth: _____ 2-1/2 in
- Cubic Inches (cm3): _____ 12.5 (204.8)
- Wt. Ea: _____ 294.835
- Length: _____ 2.50 in
- Width: _____ 7.00 in
- Height: _____ 2.20 in

PACKAGING

- PKG: _____ 50
- UPC Number: _____ 837654087589

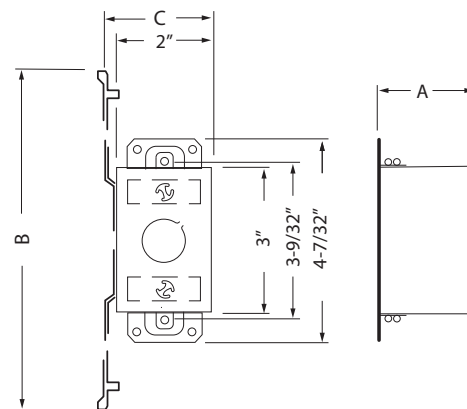
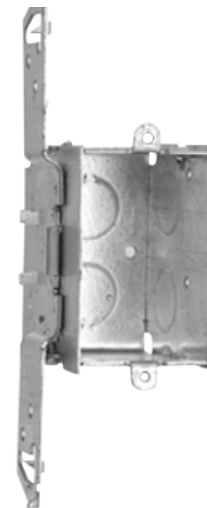

ELECTRICAL BOXES & COVERS