



CATEGORY  
**ELECTRICAL  
 BOXES**  
 AMMO ITEM #  
**AR795**

Company: \_\_\_\_\_

Job: \_\_\_\_\_ #Item: \_\_\_\_\_

Notes: \_\_\_\_\_

# 4" Square Two Device and Tile Covers Raised 1-1/2" Welded



### APPLICATIONS

- Raised device covers are used for mounting switches or receptacles
- Low voltage partitions may be added to conduit-type boxes to divide power from voice/data

### PRODUCT FEATURES

Angled mounting slots compensate up to 12 degrees for box misalignment

### CONFIGURATION

- Drawn or Welded: \_\_\_\_\_ Welded
- Raised (in.): \_\_\_\_\_ 1-1/2 in

### PRODUCT MEASUREMENTS

- Cubic Inches: \_\_\_\_\_ 15.5
- Wt. Ea. (Lbs.): \_\_\_\_\_ 0.480
- Product Length (in.): \_\_\_\_\_ 1.50
- Product Width (in.): \_\_\_\_\_ 4.00
- Product Height (in.): \_\_\_\_\_ 4.00

### PACKAGING

- PKG.: \_\_\_\_\_ 25
- Ship Carton Length (in.): \_\_\_\_\_ 13.00
- Ship Carton Width (in.): \_\_\_\_\_ 6.13
- Ship Carton Height (in.): \_\_\_\_\_ 10.75
- Ctn Weight (Lbs.): \_\_\_\_\_ 12.00
- Pallet Qty: \_\_\_\_\_ 2275
- UPC Number: \_\_\_\_\_ 837654087817

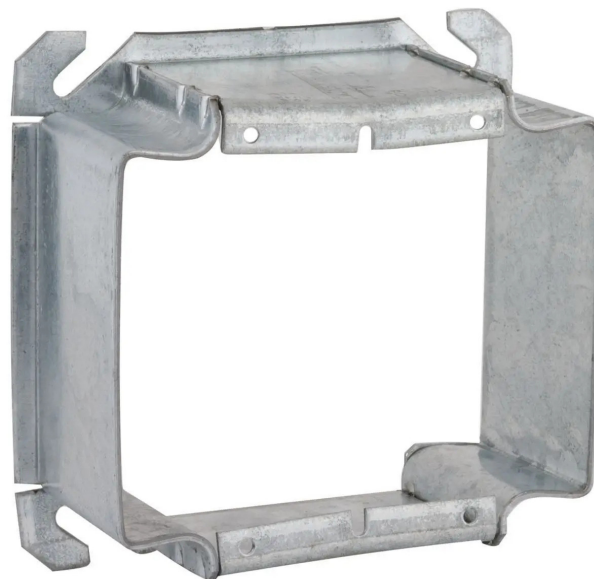

## ELECTRICAL BOXES & COVERS



400 MARTIN LUTHER KING JR WAY, BRIDGETON, NJ 08302  
 PHONE : (718).338.1851 FAX : (718).228.1851  
 orders@ammoelectric.com

www.ammoelectric.com