



CATEGORY
**ELECTRICAL
BOXES**

AMMO ITEM #

AR796

Company: _____

Job: _____ #Item: _____

Notes: _____

4" Square Cover 2-Device, 2" Raised



FEATURE BENEFIT

Raised device covers are used for mounting switches or receptacles

PRODUCT FEATURES

- Angled mounting slots compensate up to 12 degrees for box misalignment
- Steel

APPLICATIONS

Low voltage partitions may be added to conduit-type boxes to divide power from voice/data

PRODUCT SPECIFICATIONS

- Length/Depth (in.): _____ 2.00
- Width (in.): _____ 4.00
- Height (in.): _____ 4.00
- Wt. Ea. (Lbs.): _____ 0.606
- Package Type: _____ Loose
- Cubic Inch: _____ 20.7

PACKAGING

- PKG: _____ 25
- UPC Number: _____ 837654087824

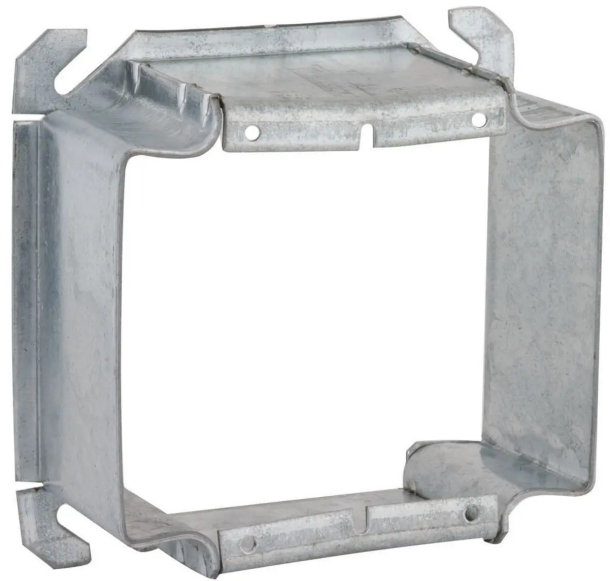

ELECTRICAL BOXES & COVERS



400 MARTIN LUTHER KING JR WAY, BRIDGETON, NJ 08302
PHONE : (718).338.1851 FAX : (718).228.1851
orders@ammoelectric.com

www.ammoelectric.com