



CATEGORY

**NEC (Nipples,
Elbows & Couplings)**

AMMO ITEM #

AREMT-15

Company: _____

Job: _____ #Item: _____

Notes: _____

EMT 15° Elbow Galvanized



AMMO#	SIZE	A (in)	B (in)	C (in)	OD (in)	THICKNESS 10% (in)	STRAIGHT LENGTH L (in)	RADIUS R (in)	WEIGHT (g)	PKG	UPC
AREMT-12515	1-1/4"	7.030	0.926	7.091	1.510±0.005	0.063	2.721	7.250	322	20	837654086285
AREMT-15015	1-1/2"	8.140	1.072	8.210	1.740±0.005	0.063	3.169	8.250	404	20	837654086292
AREMT-20015	2"	8.906	1.172	8.983	2.197±0.005	0.063	3.424	9.500	619	10	837654086308
AREMT-25015	2-1/2"	12.328	1.623	12.435	2.875±0.010	0.072	5.078	10.500	1060	50	837654086315
AREMT-30015	3"	14.212	1.871	14.335	3.500±0.015	0.072	5.748	13.000	1434	35	837654086322
AREMT-35015	3-1/2"	15.129	1.992	15.260	4.000±0.020	0.083	5.984	15.000	2177	35	837654086339
AREMT-40015	4"	17.487	2.302	17.638	4.500±0.020	0.083	7.085	16.000	2726	35	837654086346

EASY AND ACCURATE BENDING

Processed by high frequency induction welding to prevent cracking when bend

EASY WIRE PUSHING AND PULLING

Grey color epoxy resin coating with inside welding removed

HIGH CORROSION RESISTANCE

Pure zinc coating on the exterior wall with clear anti-corrosion coating finish

STANDARDS

It complies with UL797/ANSI C80.3 standards

MATERIALS

- Hot dipped Galvanized
- Galv In-line

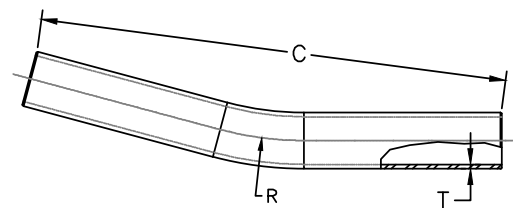
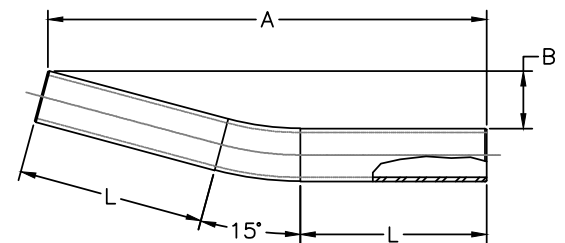
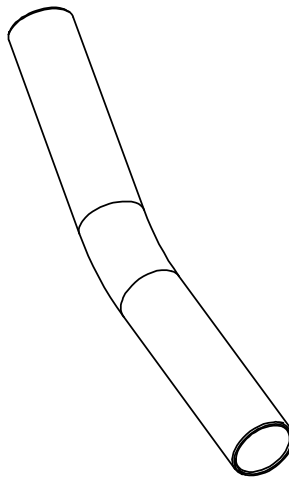

NEC (Nipples, Elbows & Couplings)



400 MARTIN LUTHER KING JR WAY, BRIDGETON, NJ 08302
PHONE : (718).338.1851 FAX : (718).228.1851
orders@ammoelectric.com

www.ammoelectric.com