



CATEGORY

NEC (Nipples,
Elbows & Couplings)

AMMO ITEM #

AREMT-45

Company: _____

Job: _____ #Item: _____

Notes: _____

EMT 45° Elbow Galvanized



AMMO#	SIZE	A (in)	B (in)	C (in)	THICKNESS T (in) +/-	STRAIGHT LENGTH L	RADIUS R (in)	WEIGHT (g)	PKG	UPC
AREMT-5045	1/2"	5.503	2.280	5.957	0.042	1.713	4.000	75	50	837654064535
AREMT-7545	3/4"	6.620	2.742	7.166	0.049	2.205	4.500	135	50	837654064542
AREMT-10045	1"	7.687	3.184	8.320	0.057	2.362	5.750	235	35	837654064559
AREMT-12545	1-1/4"	9.238	3.826	9.999	0.063	2.721	7.250	414	30	837654064566
AREMT-15045	1-1/2"	10.628	4.402	11.504	0.063	3.169	8.250	543	15	837654064573
AREMT-20045	2"	11.786	4.882	12.757	0.063	3.424	9.500	792	15	837654064580
AREMT-25045	2-1/2"	15.077	6.245	16.319	0.072	5.078	10.500	1503	50	837654064597
AREMT-30045	3"	17.767	7.359	19.231	0.072	5.748	13.000	1991	40	837654064603
AREMT-35045	3-1/2"	19.408	8.039	21.007	0.083	5.984	15.000	3151	35	837654064610
AREMT-40045	4"	21.818	9.037	23.615	0.083	7.085	16.000	3949	35	837654064627

EASY AND ACCURATE BENDING

Processed by high frequency induction welding to prevent cracking when bend

EASY WIRE PUSHING AND PULLING

Grey color epoxy resin coating with inside welding removed

HIGH CORROSION RESISTANCE

Pure zinc coating on the exterior wall with clear anti-corrosion coating finish

STANDARDS

It complies with UL797/ANSI C80.3 standards

MATERIALS

- Hot dipped Galvanized
- Galv In-line

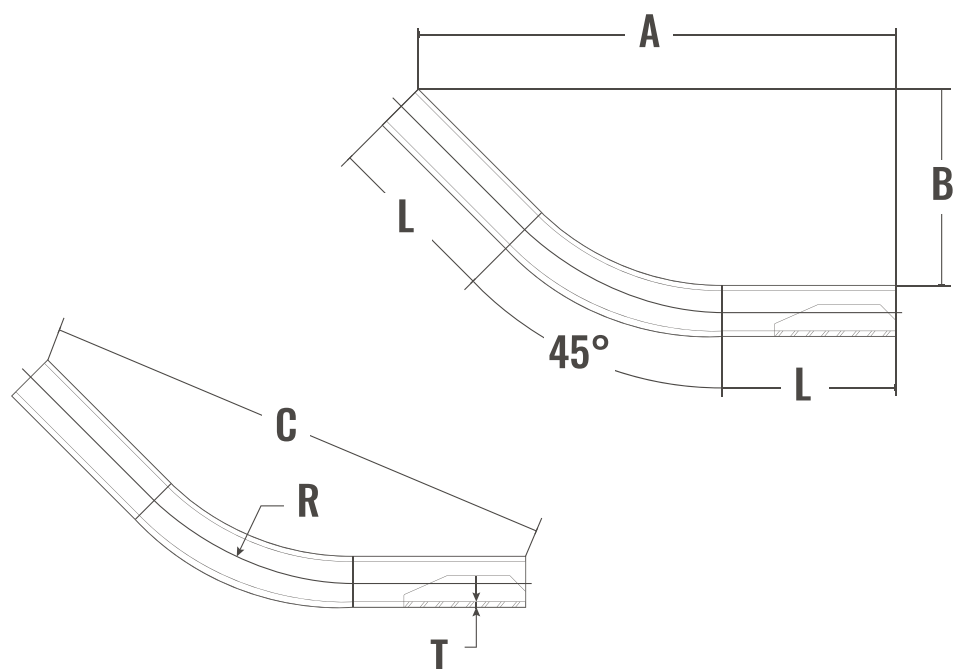

NEC (Nipples, Elbows & Couplings)



400 MARTIN LUTHER KING JR WAY, BRIDGETON, NJ 08302
 PHONE : (718).338.1851 FAX : (718).228.1851
 orders@ammoelectric.com

www.ammoelectric.com