



CATEGORY

NEC (Nipples,
Elbows & Couplings)

AMMO ITEM #

ARRE-45

Company: _____
 Job: _____ #Item: _____
 Notes: _____

Rigid 45° Standard Elbows



AMMO#	SIZE	A (in)	B (in)	C (in)	OD (in)	THICKNESS T (in)	STRAIGHT LENGTH L (in)	RADIUS R (in)	WEIGHT (g)	PKG	UPC
ARRE-5045	1/2"	6.799	2.816	7.359	0.84	0.102	2.500	4	250	50	837654064733
ARRE-7545	3/4"	7.449	3.085	8.063	1.050	0.106	2.717	4.5	364	50	837654064740
ARRE-10045	1"	8.574	3.551	9.280	1.315	0.126	2.913	5.75	627	35	837654064757
ARRE-12545	1-1/4"	10.059	4.167	10.887	1.660	0.134	3.233	7.25	965	30	837654064764
ARRE-15045	1-1/2"	11.009	4.560	11.916	1.900	0.138	3.425	8.25	1338	15	837654064771
ARRE-20045	2"	13.203	5.469	14.291	2.375	0.146	4.291	9.5	2113	15	837654064788
ARRE-25045	2-1/2"	15.548	6.440	16.829	2.875	0.193	5.354	10.5	3754	1	837654064795
ARRE-30045	3"	19.078	7.902	20.65	3.500	0.205	6.516	13	5590	1	837654064801
ARRE-35045	3-1/2"	21.023	8.708	22.755	4.000	0.217	6.930	15	8106	1	837654064818
ARRE-40045	4"	21.821	9.039	23.618	4.500	0.224	7.087	16	10055	1	837654064825

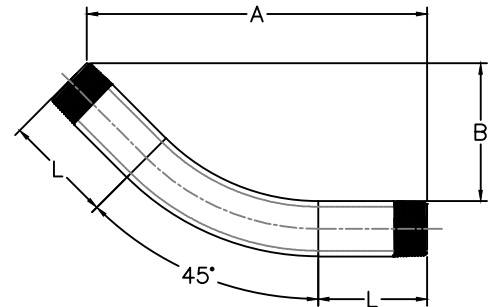
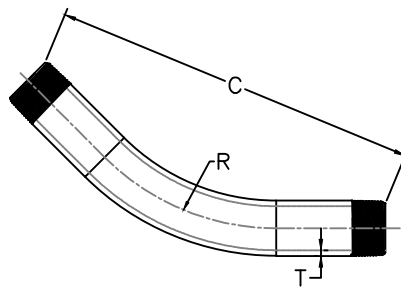
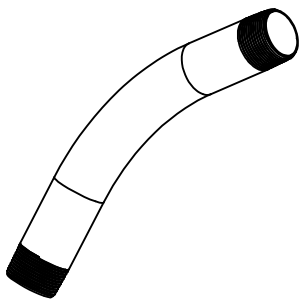

FEATURES

- Low conductivity, high corrosion resistance
- Smooth defect free interior and exterior
- It complies with ANSI C80.1/UL6 standards

MATERIAL

Galvanized steel

FINISH

Hot dip galvanized

APPLICATIONS

- For a secure connection to Rigid conduit; bend enables directional changes in conduit

NEC (Nipples, Elbows & Couplings)



400 MARTIN LUTHER KING JR WAY, BRIDGETON, NJ 08302
 PHONE : (718).338.1851 FAX : (718).228.1851
 orders@ammoelectric.com

www.ammoelectric.com