



CATEGORY

**NEC (Nipples,
Elbows & Couplings)**

AMMO ITEM #

**Rigid 22.5°
Elbow**

Company: _____

Job: _____ #Item: _____

Notes: _____

Rigid 22.5° Standard Elbows



AMMO#	SIZE	A	B	C	OD (in)	THICKNESS T (in)	STRAIGHT LENGTH L (in)	RADIUS R (in)	WEIGHT (g)	PKG	UPC
ARRE-12522	1-1/4"	8.677	1.726	8.847	1.660	0.134	3.233	7.25	740	20	837654090558
ARRE-15022	1-1/2"	9.383	1.867	9.567	1.900	0.138	3.425	8.25	1018	15	837654090565
ARRE-20022	2"	11.436	2.275	11.661	2.375	0.146	4.291	9.5	1621	10	837654090572
ARRE-25022	2-1/2"	13.769	2.739	14.038	2.875	0.193	5.354	10.5	2914	50	837654090589
ARRE-30022	3"	16.841	3.35	17.171	3.500	0.205	6.516	13	4243	35	837654090596
ARRE-35022	3-1/2"	18.307	3.642	18.666	4.000	0.217	6.93	15	6142	35	837654090602
ARRE-40022	4"	18.897	3.759	19.267	4.500	0.224	7.087	16	4688	35	837654090619

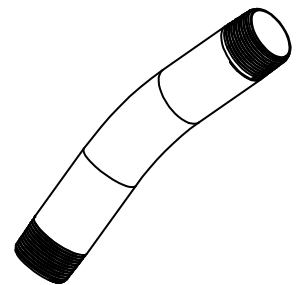
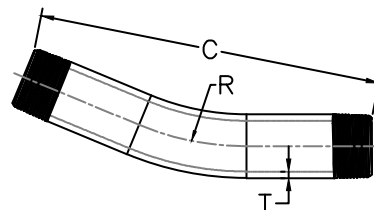
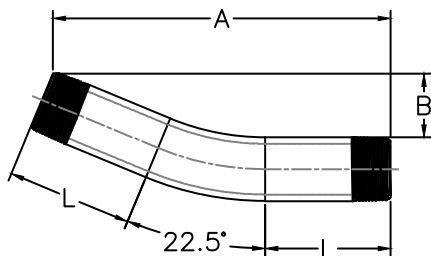

FEATURES

- Low conductivity, high corrosion resistance
- Smooth defect free interior and exterior

MATERIAL

Galvanized steel

FINISH

Hot dip galvanized

APPLICATIONS

- For a secure connection to Rigid conduit; bend enables directional changes in conduit

NEC (Nipples, Elbows & Couplings)



400 MARTIN LUTHER KING JR WAY, BRIDGETON, NJ 08302
PHONE : (718).338.1851 FAX : (718).228.1851
orders@ammoelectric.com

www.ammoelectric.com