



CATEGORY

**NEC (Nipples,
Elbows & Couplings)**

AMMO ITEM #

**Rigid 45°
Elbows**

Company: _____

Job: _____ #Item: _____

Notes: _____

Rigid 45° Standard Elbows



| AMMO# | SIZE | A (in) | B (in) | C (in) | OD (in) | THICKNESS T (in) | STRAIGHT LENGTH L (in) | RADIUS R (in) | WEIGHT (g) | PKG | UPC |
|------------|--------|--------|--------|--------|---------|------------------|------------------------|---------------|------------|-----|--------------|
| ARRE-5045 | 1/2" | 6.799 | 2.816 | 7.359 | 0.84 | 0.102 | 2.500 | 4 | 250 | 50 | 837654064733 |
| ARRE-7545 | 3/4" | 7.449 | 3.085 | 8.063 | 1.050 | 0.106 | 2.717 | 4.5 | 364 | 50 | 837654064740 |
| ARRE-10045 | 1" | 8.574 | 3.551 | 9.280 | 1.315 | 0.126 | 2.913 | 5.75 | 627 | 35 | 837654064757 |
| ARRE-12545 | 1-1/4" | 10.059 | 4.167 | 10.887 | 1.660 | 0.134 | 3.233 | 7.25 | 965 | 30 | 837654064764 |
| ARRE-15045 | 1-1/2" | 11.009 | 4.560 | 11.916 | 1.900 | 0.138 | 3.425 | 8.25 | 1338 | 15 | 837654064771 |
| ARRE-20045 | 2" | 13.203 | 5.469 | 14.291 | 2.375 | 0.146 | 4.291 | 9.5 | 2113 | 15 | 837654064788 |
| ARRE-25045 | 2-1/2" | 15.548 | 6.440 | 16.829 | 2.875 | 0.193 | 5.354 | 10.5 | 3754 | 1 | 837654064795 |
| ARRE-30045 | 3" | 19.078 | 7.902 | 20.65 | 3.500 | 0.205 | 6.516 | 13 | 5590 | 1 | 837654064801 |
| ARRE-35045 | 3-1/2" | 21.023 | 8.708 | 22.755 | 4.000 | 0.217 | 6.930 | 15 | 8106 | 1 | 837654064818 |
| ARRE-40045 | 4" | 21.821 | 9.039 | 23.618 | 4.500 | 0.224 | 7.087 | 16 | 10055 | 1 | 837654064825 |

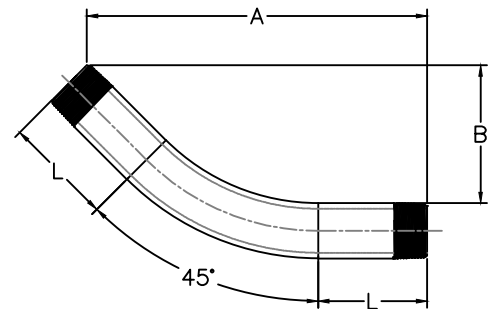
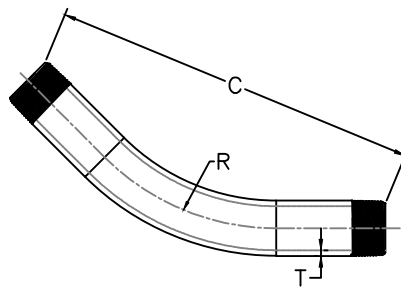
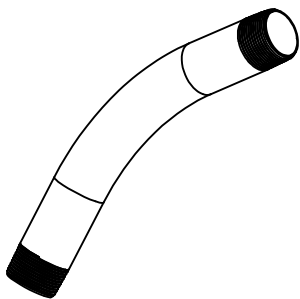

FEATURES

- Low conductivity, high corrosion resistance
- Smooth defect free interior and exterior

MATERIAL

Galvanized steel

FINISH

Hot dip galvanized

APPLICATIONS

- For a secure connection to Rigid conduit; bend enables directional changes in conduit

NEC (Nipples, Elbows & Couplings)



Ammo Electric Inc.

400 MARTIN LUTHER KING JR WAY, BRIDGETON, NJ 08302
PHONE : (718).338.1851 FAX : (718).228.1851
orders@ammoelectric.com

www.ammoelectric.com